

COMPLETE GEOCHEMICAL ASSAY SERVICES  
GLOBAL LABORATORY NETWORK  
LARGEST GLOBAL PHOTONASSAY™ CAPABILITY

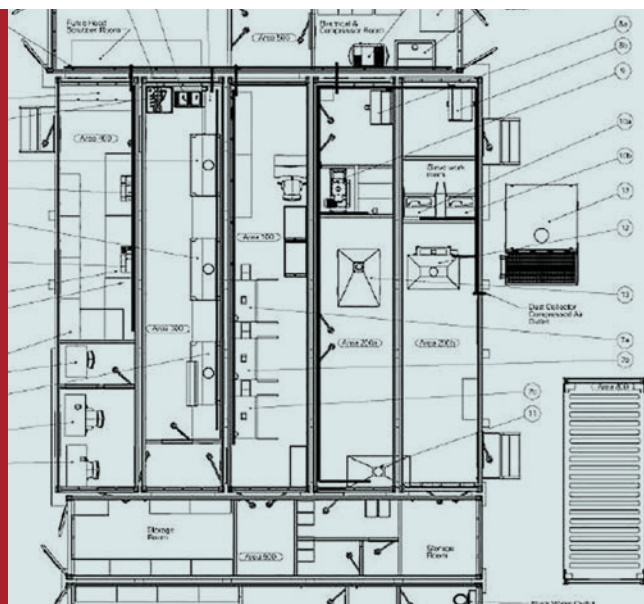

## Laboratory Design Options

**MSALABS provide a range of on-site laboratory services including design, construction, commissioning, management, software and procession.**



**Our consultation process ensures we obtain a detailed understanding of your requirements and future needs.**

## LABORATORY DESIGN

This service enables us to develop a design that will provide the most efficient laboratory solution for your individual requirements. Our solutions may range from one of our standard laboratory options to a fully bespoke design. Depending on the number of samples received, laboratories generally include a minimum of two technicians at any time.



[msalabs.com](https://msalabs.com)





## MOBILE SAMPLE PREPARATION LAB OPTIONS

We have three standard laboratory design options, for quick and easy deployment, all of which can be modified as needed to suit the individual needs of our clients.

### OPTION 1: SMALL SCALE PROGRAM

This configuration consists of a 20' container fitted with a smaller drying oven, one small crusher and one pulverizer.

This option can dry and sieve up to 300 soils and sediments per day.

This configuration is ideal for small scale grab samples, soils, sediments, rocks and occasional drill cores.

**300**  
**SAMPLES**  
Small scale samples

### OPTION 2: DD/RC MEDIUM SCALE PROGRAM

This configuration consists of a 40' container fitted with one medium drying oven, one crusher and two pulverizers.

The expected productivity is 10 drill cores (average 3kg/sample) crushed per hour and 30 splits pulverized per hour.

This configuration is optimal for a medium scale operation that's expected to prepare 80-150 samples per day of small, dryer materials such as rocks and some drill cores.

**80-150**  
**SAMPLES**  
Small, dry materials

### OPTION 3: DD/RC LARGE SCALE PROGRAM

This configuration has a larger drying oven capable of fitting four drying carts at a time.

Each drying cart can hold 50 wet samples (average 3-5kg/sample) and dry over the course of 4-8 hours.

This configuration is intended for larger scale operations that require up to 240 wet drill cores/RC samples prepared per day (dry, crush to 70% passing 2mm, 85% passing 75um).

**240**  
**SAMPLES**  
Wet samples

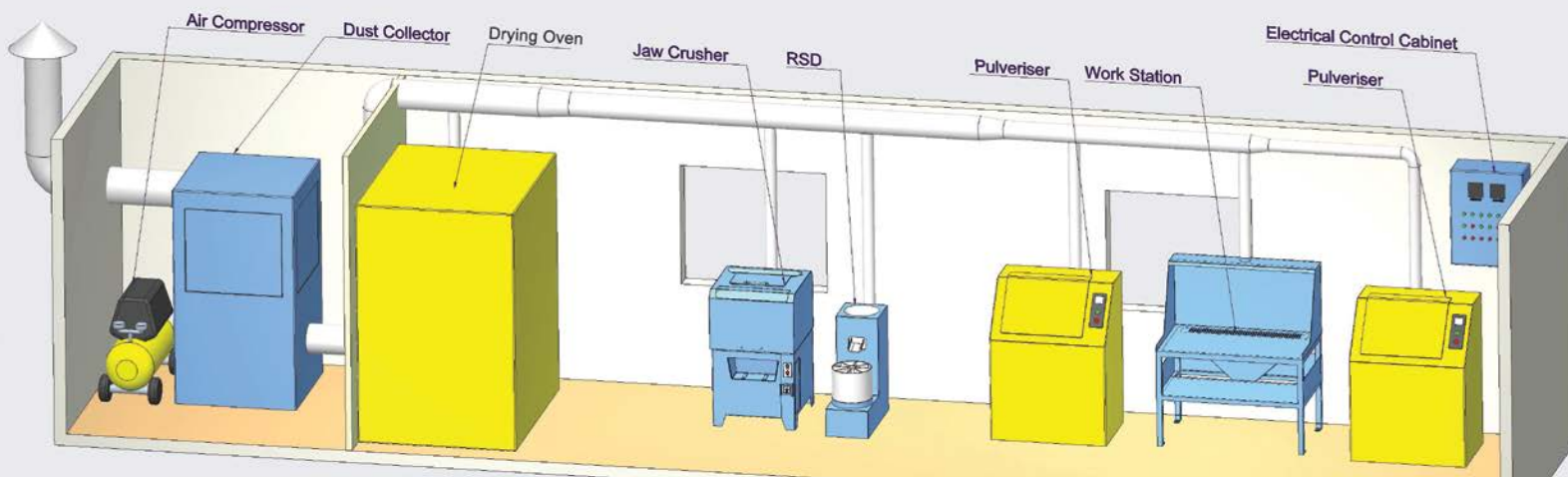

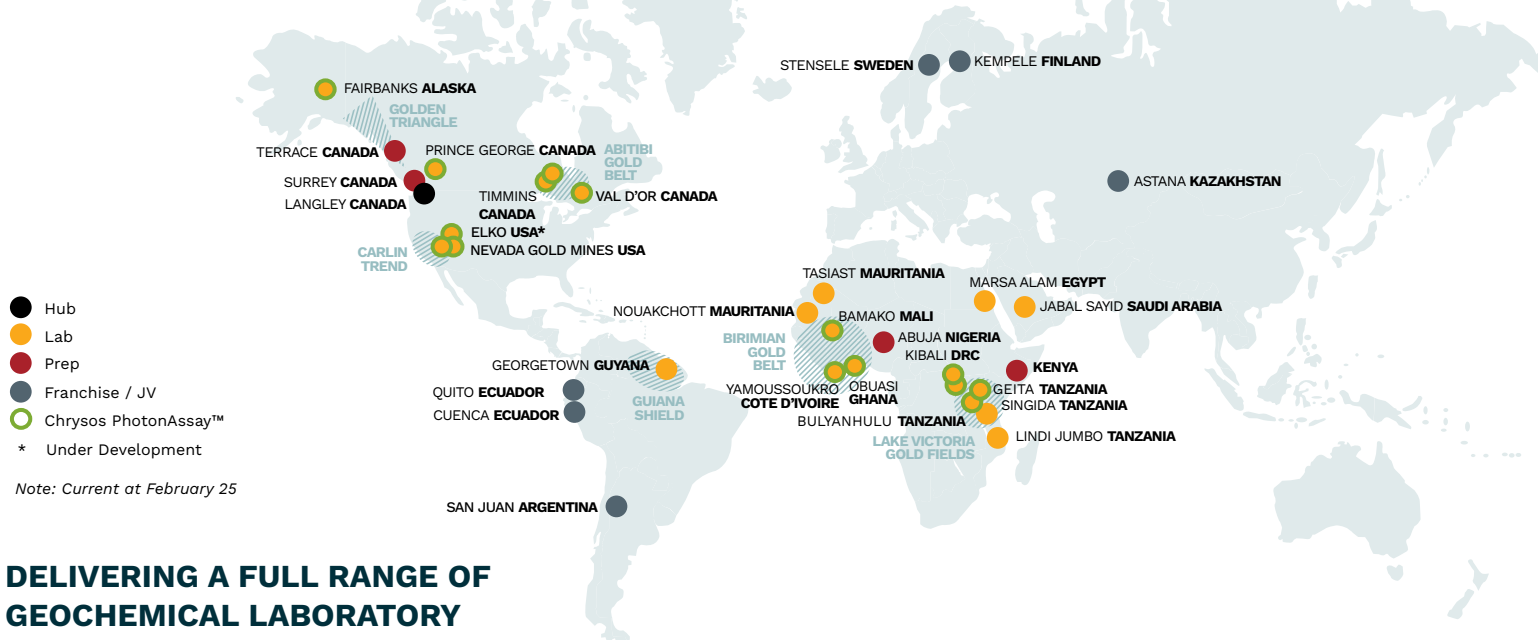

## DELIVERING A FULL RANGE OF GEOCHEMICAL LABORATORY SERVICES GLOBALLY

### EXTENSIVE RANGE OF SERVICES

- PhotonAssay™ Analysis (Gold, Silver and Copper\*)
- Sample preparation, storage and disposal
- Precious metals by Fire Assay
- Multi-element packages - Basic, Trace, Ultra-trace
- Fusion, ICP-OES and ICP-MS
- XRF
- Specialty Assay
- Biogeochemistry and Hydrogeochemistry
- Metallurgical Samples Analysis and Services
- Mineralogical Services

\* Copper assay only available in select locations and is not currently available in Canada

### STRINGENT QUALITY STANDARDS

Our company maintains the highest quality standards and follows the guidelines of ISO17025 accreditation and ISO9001, ISO14001 and ISO45001 certification. Certificates are available for download from our website.

Additionally, we participate in CDN Labs, Geostats, PTP-MAL, and Rockslabs Proficiency Testing Schemes (PTS), among others.

### EXPERTISE IN SITE-BASED LABORATORY MANAGEMENT

We have extensive laboratory design, construction and management experience in a range of countries.

We implement a complete set of systems, training, software and procedures enabling ISO certification and complete regular audits.

Our laboratories are managed by experienced, highly qualified staff, who undertake regular training.

### BROAD RANGE OF COMMODITIES

We operate across a broad range of commodities.

- Gold
- Silver
- Platinum Group Metals
- Copper
- Rare Earth Elements
- Cobalt
- Lithium
- Lead
- Zinc

### TIER 1 CLIENTS



EVERY SAMPLE **SAFELY** MEASURED  
EVERY RESULT **RELIABLY** DELIVERED

[contact@msalabs.com](mailto:contact@msalabs.com)  
[msalabs.com](https://msalabs.com)

